

DISTRIBUTION CENTER-ROCHESTER

OPEN HOUSE

SATURDAY, JANUARY 27, 1979

1:00 P.M. - 4:00 P.M.

January 27, 1979

To the Families of Distribution Center - Rochester Personnel

The men and women of Distribution Center - Rochester extend to you a warm welcome to their work place. As you tour our facilities you will see how we operate to fulfill our functions of receiving, warehousing, order processing and shipping photographic products to Kodak customers around the world.

In 1978 Distribution Center - Rochester processed 1.4 million orders for the more than 15,000 different products housed in this facility. These products range in size and complexity from the familiar cameras and film to large photofinishing processors, chemicals and copiers with each requiring its own storage and shipping environment.

We have located focal points throughout the facility to illustrate how we accomplish our stated functions. These focal points are listed in this leaflet with a map of where it is located.

We hope that your visit is enjoyable and that you leave with a better understanding of the important contributions your loved ones make to Distribution and the Eastman Kodak Company.

Dick Whitney

Distribution Center - Rochester

WR:DW:tr

Distribution Center - Rochester
Building 605

1. Area - Approximately 1.7 million square feet
2. Room size - 40,000 square feet
3. Capacity - Approximately 102,000 pallets
4. Temperature - one room 35°
 - eight rooms 55°
 - all others 70°
5. Features - volatile chemical storage vaults
 - air curtains
 - modular construction
 - 121 enclosed truck docks
 - 15 enclosed rail docks
6. Dragline - approximately 2 miles long
 - capacity of 350 carts
 - travels at a rate of 90 feet/minute
7. Employment - 329 people

DISTRIBUTION CENTER - ROCHESTER

BUILDING 605

1, 2 Room Number

①, ② Point of Interest

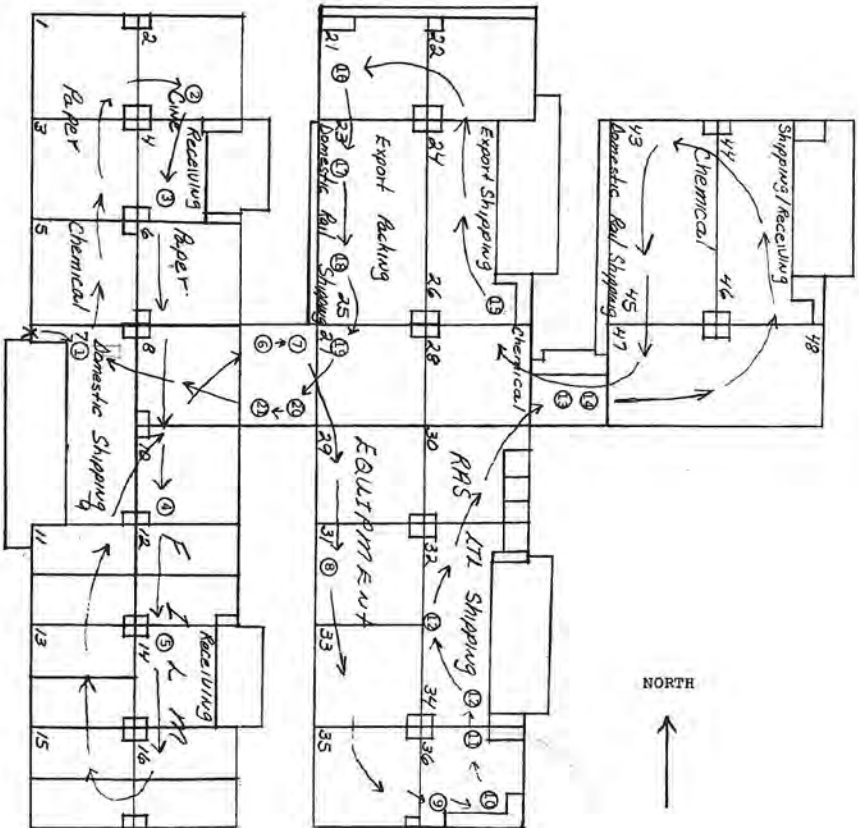

Points of Interest

1. Domestic Shipping - Open Truck (Room 7)
 - Packing Display
 - Shipping Records
2. Cine Warehouse - Product Display (Room 4)
3. Paper Warehouse - Product Display (Room 4)
4. Chemical Warehouse - Publication Display (Room 10)
5. Film Warehouse - Receiving Operation (Room 14)
6. Control Center - Dragline Monitors (Room 20)
 - Weather Monitors
 - Alarms Monitors
7. Cafeteria - Refreshments (Room 20)
 - Clowns
 - Slides
8. Equipment Warehouse - Camera Display (Room 31)
 - Kit Display
9. General Office (Room 36)
10. In-House Computer (Room 36)
11. Control Group - Printers (Room 34)
 - Electrowriters
12. Domestic Shipping - Open Trailer (Room 34)
 - Shipping Locations Display
13. Seminar Room - Pictures (Room 40)

Points of Interest
(Continued)

14. Rochester Adjustment Service Office (Room 40)
15. International Shipping - Open Container (Room 26)
 - Trailer Display
 - Air Freight
16. Machinery Crating - Nailing machine (Room 21)
 - Bulk Heads
 - Break Bulk
17. Shrink Wrap Machine (Room 23)
18. Domestic Shipping - Open Rail Car (Room 23)
19. Chemical Warehouse - Advertising Display (Room 27)
20. Facilities Group - Equipment Display (Room 20 N Crib)
21. Power Equipment Demonstration (Room 20 Truck Shop)

Smoking is permitted in smoke rooms, cafeteria,
and seminar room only.

Report any problem to Building Facilities,
Phone (beige phone) 143 or 147.

Parents are asked to keep safety in mind and to be
aware of their children's actions and whereabouts at
all times.

Personal property is subject to inspection upon
leaving Eastman Kodak property.