

# LYCEUM THEATRE



PLAYING ONLY  
FIRST CLASS ATTRACTIONS

*Rochester, N. Y.*

Phone for Appointment Stone 2450

## THE BOBBING SHOPPE

FRED MAISENBACHER, Manager

Bobbing, Curling, Marcelling,  
Manicuring, Massaging  
Shampooing

Children's Bobbing a Specialty  
Office No. 9, 133 Clinton Avenue S.  
Rochester, N. Y.



## YOUNG'S

Shell Oyster and Fish Market—Oysters and  
Clams on Half Shell Delivered Ready to  
serve—All Kinds of Sea Food in Season—  
Lobsters, Shrimps, Etc.

Phone. Main 3985-7993—We Deliver

114 Main St. West

FOR SPACE IN THIS

PROGRAM

CALL

W. F. FAGAN

Genesee 2287 R

## B. J. HENNER CARTING and STORAGE CO.

GENERAL CARTING

Office and Storage, 92 FRONT ST.

Phone: Main 7896

## SAY IT WITH FLOWERS

BUT SAY IT WITH OURS

You will save 50% by ordering  
the Flowers from Collatos Bros.

Open 7:30 A. M. to 10:30 P. M.,  
including Sundays and  
Holidays.

We Deliver to All Parts of  
the City

## COLLATOS BROS.

49 CLINTON AVE. S.

Stone 329



THE THREE MUSKETEERS

"Grease, Gas and Oil—the motordom musketeers  
—stand guard with their usefulness, over the existence  
of your car."

—P. Troleum.

**F**AILING in their duty—your car  
soon depreciates to almost nothing  
in value. With dependable qual-  
ity and perfect balance.....gas  
and.....oil will keep your car in  
good running trim every day in the  
year.

Park where your car is insured, at

**MacLean's Service Station,**  
Incorporated  
COURT and STONE STREETS  
Main 5138

# PROGRAM

MONDAY — TUESDAY — WEDNESDAY

3 NIGHTS — October 5th—6th—7th — 3 MATINEES

"Once before we mentioned the fact, when you heard of a musical show's being notable for its good singing and superior score you are likely to find that it is presented by the Messrs. Shubert. While the present season offers several productions which are musically remarkable, the fact still remains that 'The Student Prince' and 'The Love Song' are in the first rank of shows to which you would not be ashamed to take a real musician, and they fly the Shubert banner."  
—ROBERT BENCHLEY in "LIFE."

THE MESSRS. SHUBERT

present

THE SPECTACULAR OPERETTA

## THE STUDENT PRINCE

IN HEIDELBERG

Book and Lyrics by Dorothy Donnelly

Book and All Ensembles Staged by J. C. Huffman

Dances by Max Scheck

Orchestra under the direction of Mr. Fred Quintrell

Music by Sigmund Romberg

Settings by Watson Barratt

Settings by Watson Barratt

Entire Production under the Personal Supervision of J. J. Shubert

For Space in This Program Call W. F. Fagan, Genesee 2287-R

## Automatic Refrigeration with Your Own Ice Box

Let us install SERV-EL Automatic Refrigeration in your own ice box.

SERV-EL cooling tank can be installed in the ice compartment with mechanism in basement or other convenient place and will keep your ice box colder than is possible with ice.

SERV-EL will make plenty of Pure Ice Cubes for table use. See this wonderful machine in operation at our store.

### Rochester and Gas Electric Corp.

Phone, Main 3960



*“’Tis Sleep Knits Up the  
Raveled Sleeve of Care.”*

So wrote Shakespeare, long ago,  
and the words are as true today as  
ever. With so much of one's life  
spent in sleep, the softer the bed  
the sweeter the slumber.

However simple or elaborate the bed, it is the bedding  
that brings restful sleep. We have a very desirable

**All-Cotton Layer Felt Mattress**  
at the low price of \$15.00

**MAMMOTH ASSORTMENTS** **H.B. GRAVES CO.** **WE FURNISH HOMES COMPLETE**  
78 STATE ST., ROCHESTER, N.Y.

WATCH FOR THE  
OPENING

of the

## FRENCH GRILL

“ROCHESTER'S NEWEST  
RESTAURANT”

FRENCH CUISINE

DINNER CONCERTS

and After Theatre Dancing in  
Blue Room

Under Management of

**M. A. ALBERT**

formerly with Sagamore

The Originator of the Sea Shell

HIGH CLASS

TAILORING

at

REASONABLE

PRICES

## CHARLES RUMPF

Merchant Tailor

305-306 DAKE BUILDING

Rochester, N. Y.

Stone 3377

# ALL THIS WEEK ---

SPECIAL MUSIC BY THE SAX SMITH  
ORCHESTRA DURING DINNER HOUR  
AND AFTER THEATRE FOR DANCING

Odenbach  
Coffee Shoppe  
Few Doors  
North  
Across sStreet

*The Odenbach*  
*Restaurant*  
ROCHESTER N.Y.

SOUTH AVE. near MAIN

## PROGRAM—Continued

### THE CAST

First Lackey .....	Robert Dunn
Second Lackey .....	Lindsey Campbell
Third Lackey .....	Martin Griffith
Fourth Lackey .....	Frank Guild
Von Mark .....	Thurlow Bergan
Dr. Engle .....	Vernon Jacobson
Prince Karl Franz .....	Sudworth Frazier
Ruder .....	Albert Froom
Gretchen .....	Emmie Niclas
Toni .....	Nathaniel Sack
Detleff .....	David Reese
Lucas .....	Hedley Hall

## OUR HUMBLE AIM—

is to make people comfortable by making their homes sanitary, liveable and healthful.

PLUMBING and HEATING  
SINCE 1885

**HOWE & BASSETT CO., Inc.**

23-25 STILLSON STREET

The Lyceum Theatre

Recommends to its

Patrons

**YELLOW CABS**

Main 2200

**OPERATING** the largest Dry  
Cleaning and Dyeing plant  
in the state, outside of New  
York City!

# **STAUB & SON**

**INCORPORATED**

Rochester's Leading Dry Cleaners and Dyers

951-961 MAIN STREET EAST

82 East Ave. — Branch Stores — 70 Clinton Ave. So.

Chase 1151, 1152, 1153, 1154

**FOR SPACE IN THIS  
PROGRAM**

**CALL**

**W. F. FAGAN**

**Genesee 2287 R**

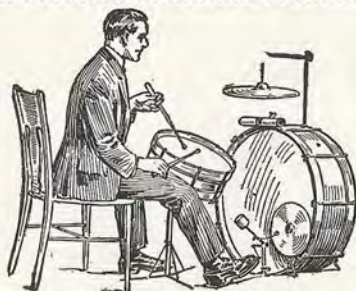

**DRUMMER'S  
OUTFITS  
\$20 UP**

**LUDWIG & LUDWIG and  
LEEDY DRUMS**

**Every Accessory the Drummer Needs!**

**WHEN YOUR WANTS ARE MUSICAL COME TO**  
**LEWIS MUSIC STORE**  
EVERYTHING IN MUSIC AND MUSICAL INSTRUMENTS-PANOS-PIANOS-ORGANS  
**612 E. MAIN ST. 39 SOUTH AVE.**

Phone, Main 5123

# James Conolly Co.

PRINTERS AND PUBLISHERS

29 North Water Street

Rochester, N. Y.

## PROGRAM—Continued

Von Asterberg .....	A. W. Callam
Nichilas .....	Fred Gregor
Kathie .....	Eliz Gergely
Lutz .....	Percey Hemus
Hubert .....	Alec Harford
Grand Duchess Anastasia .....	Bell Sylvia
Princess Margarete .....	Margaret Cantrell
Captain Tarnitz .....	Warren Hull
Countess Leyden .....	Nellie Strong
Baron Arnheim .....	Robert Adams
Premier Dancer .....	Cecille Bronson
Rudolph Winter .....	Ed Flynn
Freshman .....	Ben Rosenthal
Captain of Guard .....	Sam Goodman

ACROSS THE STREET  
in the  
TEMPLE THEATRE BLDG.

EDITH ELLIS  
SWEET SHOP

KITCHEN COOKED SALTED  
NUTS

HOME MADE CANDIES  
LUNCHES SODA

When You Smile depends on how  
often some girl thanks you  
for her wonderful box of

*Whittle's*

CANDIES  
on sale at

3-5 East Ave. 44-46 Main St. E.  
Candies, Ice Creams and Sodas

ANNOUNCING THE RESUMING  
of  
*Saturday Night Supper Dancing*  
at  
**THE HOTEL SENECA**

**SATURDAY  
NIGHT  
October 24th**

Will open the season of Supper Dancing in the Pompeian and Crystal Dining Rooms. The Metropolitan atmosphere and excellent Cuisine of these two rooms combined



The Crystal Room



The Pompeian Room

with the Symphonic dance music of Gilbert Owens' New Seneca Orchestra will insure a most delightful evening. The Service will be A la Carte with cover charge of \$1. Dancing from 10 p. m. until closing.

Reservations and arrangements for parties can be made with the Maitre D'Hotel.

H. Stanley Green - - - - - Manager





## *The New Cadillac* *and the new values*

The new models, at substantially lower prices, are now on display in Rochester. A ride in one is a Revelation—You are cordially invited to try it.

*Advance orders  
are breaking all records*

MABBETT MOTOR CAR COMPANY, Inc.

157-167 COURT STREET

# ZOE LOUISE PUTNAM BEAUTY SALONS

Located at

**HOTEL SENECA — WOMEN'S CITY CLUB**  
in the Arcade 33 Chestnut St.

Two conveniently located beauty salons for the Rochester Girl or Woman who desires distinctiveness in the cutting and arrangement of her hair.

---

**American and European Barbers Featuring the  
Latest Mode in Hair Bobbing**

**16 Expert Beauticians Specializing in Fine**

**MARCELLING WATER WAVING  
FACIALS MANICURING**

**and all Branches of Modern Beauty Culture**

**PERMANENT WAVING**  
by the Famous Nestle Lanoil Method

Beautiful soft and natural looking waves which give that smart appearance which will last for many months.

Make Your Next Appointment in a

**ZOE LOUISE PUTNAM  
BEAUTY SALON**

**SENECA SALON — WOMEN'S CITY CLUB**

Main 6947

Main 4748

**SALON**

Stone 2898

## PROGRAM—Continued

**FLOWER GIRLS**—Misses Florence O'Brien, Christein Ellmin, Dorothy Ives, Alma Willis, Evelyn Pierce, Dorothy Lyons, Frances Berrigan, Mary Alden, Lee Krone, Lee Wiles, Martha Wurm and Betty Fator.

**MAIDS**—Misses Belle Flower, Marie Neidbalska, Isabel Parkman, Marie Endicotte, Tina Carma, Janette Yanover, Philomene Vysocka, Maida Vale, Betty Fator and Martha Wurm.

**WAITERS**—Thomas Connor, Henry Kessler, Harry Lessman, Eddie Greene.

**GUESTS AT THE PALACE**—Misses Lee Krone, Frances Berrigan, Bell Flower, Marie Neidbalska, Florence O'Brien, Maida Vale, Mary Alden, Betty Fator, Alma Willis, Marie Endicotte, Christein Ellman, Dorothy Ives, Tina Carman, Philomene Vysocka, Lee Wiles, Evelyn Pierce, Dorothy Lyons, Martha Wurm, Mae Valle and Marjorie Carroll.

**STUDENTS OF HEIDELBERG, SAXONS**—Albert Henkel, Ben Rosenthal, Valdimier Chardaroff, Robert Abbott, Sam Goodman, Walter Brennan, Geo. Wilcox, Ed. Massey, Ralph Dunn, Frank Guild, Lew Lesser, Fred Gregor, Henry Keller, A. E. Hall, Ben Lewis, James Kelley, Lawrence Clark, Robert Adam and Robert Long.

**STUDENTS OF HEIDELBERG, RHEINSHERS**—Angelo Bochetti, Billy Hall, Ed Jones, Thomas Rice, Leo Gauthier, Henry McEachern, Charles Sultan, Joseph McGurgan, Jack Kierman, Jas. Berry, Harry Rose, Harold Stout, Thomas Hughes, Geo. Milbauer, Paul Wilcox, Jack Williams and Wm. Lancaster.

---

## SYNOPSIS OF SCENES

TIME—Spring, 1860

PROLOGUE—Ante-chamber in the Palace at Karlsberg

ACT I—Garden of the Inn of the Three Golden Apples. At the University of Heidelberg

ACT II—Sitting room of Prince Karl, at Inn. Four months later

ACT III—A room of state in the Royal Palace at Karlsberg. Two years later.

ACT IV—Same as Act I. (Garden of the Inn). The next day

---

## MUSICAL PROGRAM

Orchestrations by Emil Gerstenberger

### PROLOGUE

- 1 "By Our Bearing So Sedate".....Four Lackeys
- 2 "Golden Days".....Prince, Dr. Engel

### ACT I

- 3 "Garlands Bright".....Ruder, Gretchen, Flower Girls, Waitresses
- 4 Drinking Song ..... Detlef and Students
- 5 "To the Inn We're Marching".....Detlef, Von Asterberg, Lucas, Kathie, Students
- 6 "You're in Heidelberg".....Prince, Dr. Engel
- 7 "Welcome to Prince".....Kathie, Ruder, Gretchen, Girls
- 8 Duet—"Deep in My Heart, Dear".....Prince and Kathie
- 9 Serenade.....Prince, Detlef, Lucas, Von Asterberg and Students
- 10 Finale .....Prince, Kathie, Detlef, Lucas,  
Von Asterberg, Ruder, Lutz, Dr. Engel, Gretchen, Hubert, Students, Girls

### ACT II

- 11 Opening—"Farmer Jacob" .....Detlef, Students
- 12 "Students' Life" ..... Prince  
Kathie, Dr. Engel, Gretchen, Detlef, Lucas, Von Asterberg, 8 Students
- 13 Duet—"Farewell, Dear".....Prince and Kathie
- 14 Finale, Act II.....Prince, Kathie, Van Mark, Dr. Engel

### ACT III

- 15 Opening—"Waltz Ensemble" ..... Ambassadors,  
Officers, Countess Leyden, Baron Arnheim, Ladies of the Court
- 16 Solo Ballet .....Premier Dancer (Miss Mason)
- 17 "Just We Two".....Princess, Tarnitz, Officers

# NORMANDIE APARTMENTS

253 ALEXANDER STREET

Noted for Its Service and Homelike Atmosphere

1, 2, 3 and 4-Room Units  
Furnished and Unfurnished

REASONABLE RATES

166 Apartments, 166 Baths, Restaurant and Delicatessen

## PROGRAM—Continued

- 18 "Gavotte".....Karl Franz, Princess, Countess,  
Baron Arnheim, Tarnitz, Officers, Ambassadors, Ladies of the Court  
19 "What Memories" ..... Prince  
20 Finale ..... Prince, Kathie, Dr. Engel

### ACT IV

- 21 Opening—"Sing a Little Song".....Students, Girls  
22 "To the Inn We're Marching".....Detlef, Von Asterberg, Students  
A—"Serenade" ..... Detlef, Students  
B—"Come Boys".....Students, Detlef, Von Asterberg  
23 Finale—"Deep in My Heart, Dear.....Prince, Princess, Kathie, Winter,  
Gretchen, Hubert, Lutz, Duchess, Detlef, Von Asterberg, Students, Girls

---

Costumes for the Third Act designed and executed by Weldy of Paris  
Costumes, First and last Act, by Vanity Fair Costume Company  
Costumes worn by chorus in First and Fourth Acts made by Lido Voile; created  
by Cohn-Hall-Marx Co., New York

Shoes by I. Miller and Barney  
"Flaming Youth" and "Ensemble" brassieres by Model Brassiere Co., Inc.  
Furnishings by Nat Lewis. Scenery executed by United Scenic Studio

## "A TONE LIKE HOME"

# THE OSBORN HOUSE

NOON-DAY LUNCH, 12 to 2 p. m., with varied assortment of a  
la carte dishes and special 75c lunch

DINNER, 6 to 8 p. m. UNUSUAL EXCELLENCE, \$1.00

SUNDAY DINNER, 12:30 to 2:30 and 6 to 8 p. m., a special  
attraction—Quality, Quantity, Service Unsurpassed

Private Dining Rooms for Banquets, Business Men's Meetings, Card Parties, Etc.  
SATISFACTION GUARANTEED

FRANK J. PETERS, Manager

MILTON ROBLEE, Proprietor



## Follow the Leaders

Wheeler Wadworth, Paul White-  
man, Paul Specht and most head-  
liners are using

# BUESCHER

SAXOPHONES  
and Band Instruments

FREE TUITION  
CONVENIENT TERMS



Ludwig, Vega, Weyman & Orpheum Banjos, Ludwig Drums,  
Martin Ukcs—Music, Methods and Collections  
We Invite Your Account

## ROCHESTER MUSICAL INSTRUMENT CO.

53 South Clinton, near Keith's

Catalogs on request

Phone, Main 6699

### PROGRAM—Continued

Properties by the Shubert Property Shop

Business Manager .....	Sidney Smith
Manager of Company .....	Moe Wise
Stage Manager .....	Jack Bell
Assistant Stage Master .....	Wesley Spears
Chorus Master .....	Fred Gregor

## BEAUTIFUL DANCING ATMOSPHERE

SEA FOOD

and

SHORE DINNERS

SPECIAL 12 to 2

Chicken, Steak and

Duck Plate

Dinners, \$1.50

While in Rochester  
Visit Tent

at

# KOLB'S INN

Frank J. Kolb, Prop.

Chili and Brooks Aves.

Dancing, 9:30 to 2 A. M.  
Manning's Own Orchestra

During Sept., Oct. & Nov.

CLAM BAKE DINNERS

Served on Sundays

from 3 to 9

Main St. W. to Chili Ave.

DIRECT TO KOLB'S



# THE LAUGH SENSATION OF THE WORLD!



*"The audience remained five minutes after the final curtain to cheer"* -N.Y. TIMES

*"Moved audience to alternate shrieks of amazement and hilarity from start to finish."* -BOSTON HERALD

# THE GORILLA

*"Real scream of a mystery play one of the most successful dramas ever acted."* -CHICAGO DAILY NEWS

*"One of the funniest plays seen in London in a long time."* -LONDON DAILY MAIL



## PRICES:

Nights—\$2.50, \$2.00, \$1.50,  
\$1.00, 50c  
Sat. Mat.—\$1.50, \$1.00, 50c



Friendly advice:  
**SECURE SEATS NOW**

## "THE GORILLA"

"The Gorilla," a parody on the mystery play craze which threw New York, Boston, Chicago and London playgoers into a paroxysm of laughter during its brilliant runs, is coming to the Lyceum Theatre for three nights, beginning Thursday night, October 8th, with matinee Saturday, when it will be presented by a special company with the original scenic production. It is by Ralph Spence, whose scintillant humor has shone resplendently in the "Follies" and other notable productions. Spence has also contributed to the films, having written some of Harold Lloyd's biggest laughing hits. In "The Gorilla" he is said to have conceived one of the most original and merriest conceits seen on the stage in recent years. In "The Gorilla" he has every situation, new and old, that is surefire, even down to an "Uncle Tom's Cabin," and all the moving scenery, stage traps, hidden closets and dark stage grewsomeisms. It is a melange of chills, thrills and yells, while the notable mystery plays are satirized with a seriousness that makes it all the merrier.

Mr. Mulligan and Mr. Garrity, the detectives, are said to be among the most amusing of stage characters. It is a question which is the dumber and their constant blundering is responsible for a series of mirth-provoking complications. One of the best and original hits in playing the audience enlivens the closing moments and it must be seen to be properly appreciated. All the mechanical tricks known to mystery plays are introduced and they add effective realism to the whole. It is said that the scenes are so robustly exaggerated that they are rewarded with screams—some of them just screams and most of them screams of laughter. The play opens in a drawing room and most of the scenes where the mysteries thicken are laid in a basement and a garage. In the special company assembled for this tour are: Matt Hanly, Joseph Lanigan, Booth Howard, John Clubby, Joseph Barrett, Henry Crosby, Jack La Rue, Marion Hazlup, George Fogel and others. Seats now.

## NOTICE

Look around and choose the nearest exit to your seat. In case of excitement, walk, don't run, to that exit. Do not try to beat your neighbor to the street.

HARRY J. BAREHAM

## LYCEUM THEATRE COMPANY

J. S. Wolf, President

Simon N. Stein, Vice President

Rudolph Stein, Secretary and Treasurer

### DIRECTORS

J. S. Wolf

Simon N. Stein

M. E. Wolf

Nat S. Woff

Rudolph Stein

### BUSINESS STAFF FOR THEATRE

F. J. MENNELLEY, Representative

Hattie Lutt } Ticket Agents

Ralph Kohl }

George Minges, Musical Director

John Tierney, Stage Manager

Chas. Heltsman, Property Master

Frank Muntz, Electrician

Thos. Copithorn, Advertising Agent

### HOUSE NOTICES

Box Office open 9 A. M. to 9 P. M.

Matinees begin at 2:15, and evening performances at 8:15 promptly.

Seats for this theatre may be obtained by mail, telegraph or telephone Main 135, and will be held until such time as agreed upon when order is given. If not called for then, they will be sold.

Ladies' Parlor and Toilet Rooms. Orchestra Circle, right of Main Entrance.

Smoking Room and Gentlemen's Parlor and Lobby—first door to right. Smoking positively forbidden in any part of the Lobbies of this Theatre.

Free Check Rooms for cloaks, coats and umbrellas in Lobby, left of Dress Circle Entrance.

Wet Umbrellas not allowed in Orchestra Circle, Orchestra or Balcony.

Parties finding lost articles in any portion of the Theatre, will please leave them at the Box Office.

No fees of any kind allowed to ushers or attaches of this Theatre.

Patrons will please report to the manager in person or by letter, instances of inattention or misdemeanor on the part of the attaches of this Theatre.

Special attention is called to the safety of the Theatre. Located on the ground floor with exits on all four sides, provided with an asbestos curtain covering entire proscenium so that in case of fire on the stage it would be impossible to communicate to auditorium. The Balcony and Gallery have iron stairs on both sides, leading to the walk which together with main entrance built of iron and brick, will be opened at the close of each performance, or sooner if necessary. The side doors in the Orchestra Circle will also be opened at the close of every performance.

The asbestos or fire curtain will be raised upon the entrance of the orchestra. The stage is equipped with water curtain, sprinkler system, stand-pipes and coils of hose connected directly with the Holly water service.

Ladies, excepting those occupying seats in the last row, must remove their hats during the performance. It is hoped the ladies will assist us in this respect.

### RED LIGHTS IN THIS THEATRE INDICATE EXITS

Haines Bros. Pianos used in this Theatre

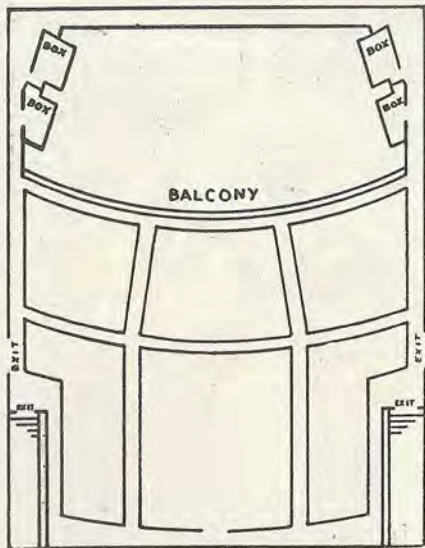
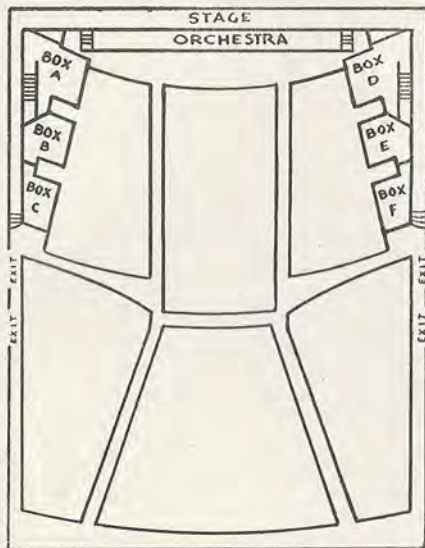



# Kenealy

wants to see you

GOOD FOOD AT SENSIBLE PRICES



---

**ROAST CHICKEN DINNER** **50c**  
with Dressing and Potatoes

---

**FLUFFY HOT WAFFLES** **20c**  
with Pure Creamery Butter and Syrup

---

**BREAKFAST SPECIAL** **35c**  
Fresh Baked Apple  
Two Strictly Fresh Eggs  
Two Slices Crisp Buttered Toast  
Large Cup of Good Coffee

---

**FRESH ROAST  
CHICKENS**

WITH DRESSING

**\$1.35**

To Take Home in a Box

---

SEVEN RESTAURANTS

---

